

Verity Lounge Series — VL-100/200/300-FA-BH

Product Documentation



This document includes:

01

End of life and Recovery options

Disassembly Instructions

Verity Lounge Series- VL-100/200/300-FA-BH

Time Required: Approximately 20 minutes

These instructions may be used to disassemble all models in the Verity Lounge collection.



Tools Required

Power Drill

Various Bits

Pry Bar



Utility knife

Right Angle Drill



Step 1

* If your unit is equipped with arm caps use the pry bar to separate the arms caps at the front, middle, and back of the arm. If not proceed to Step 2.

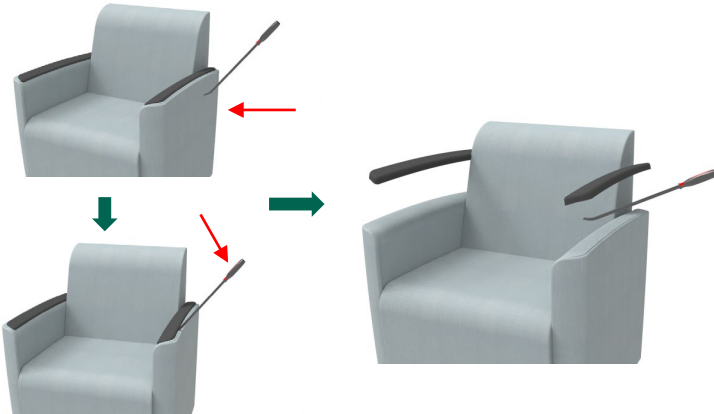

Step 2

Flip the chair over onto the seat/back exposing the bottom of the chair.

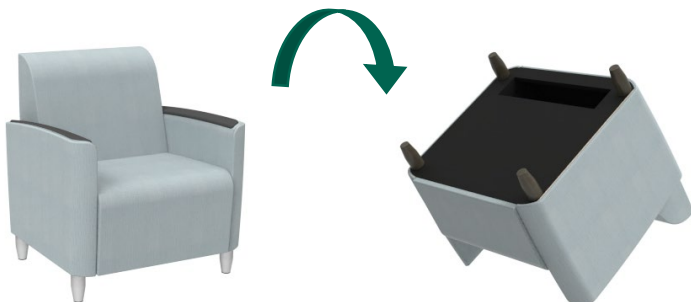

Step 3

Remove all 4 legs. Follow the instructions that match your units' leg option.

Metal Leg

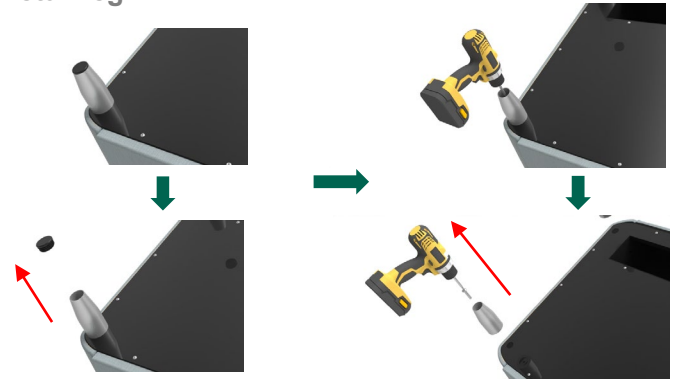

Wood Leg

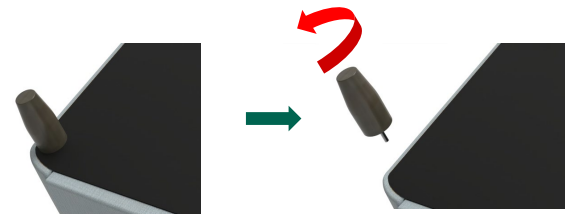

Glide



Disassembly Instructions

Verity Lounge Series- VL-100/200/300-FA-BH

Step 4

* If your unit is equipped with a seat pan, remove the screws along the perimeter and detach the seat pan. If not proceed to step 5.

VL-100/200/300-BH

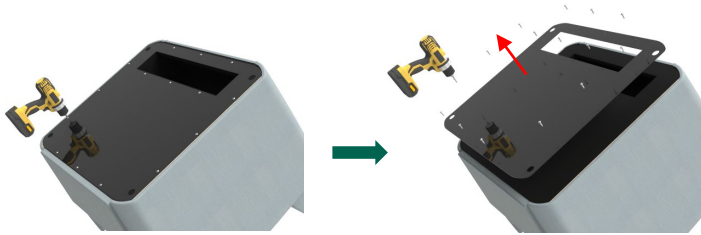

VL-100/200/300-FA

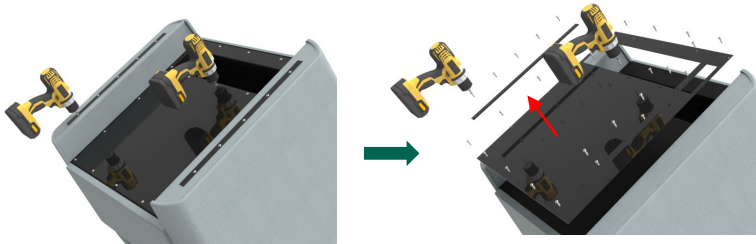

Step 5

Using a utility knife remove the dust cover to expose the inside of the chair.



Step 6

Remove the 4 screws attaching the seat and back frame to the arm panel. Repeat for both sides. (shown as cross section)

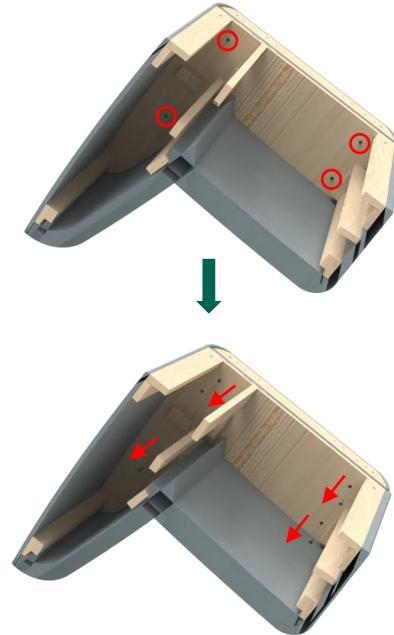

* Screw removal may require the use of a small space drill or an angle driver.

The seat box and back frame are now free to be separated from the arms. Disassembly is complete.

Material Breakdown

Verity Lounge Series- VL-100/200/300-FA-BH

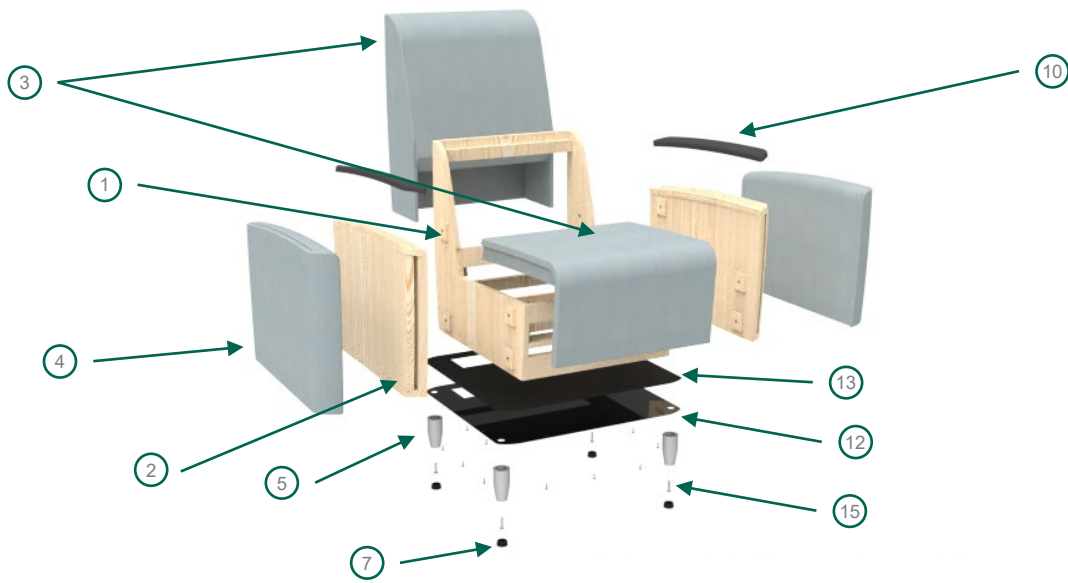

Upholstery and foam Removal

Seat, Back, and Arms

Using a knife (preferably a box cutter) carefully slice the upholstery around the bottom of the seat, back, and arms so that the upholstery is free from the staples. Remove the upholstery. Taking the knife again, carefully slice the foam away from the wood framing of the seat, back, and arms.

Number	Quantity	Component	Material
1	1	Seat and Back frame	Plywood
2	2	Arm frame	Plywood
3	1	Seat and Back foam	Polyurethane foam
4	2	Arm foam	Polyurethane foam
5	4	Metal legs optional*	Steel
6	4	Wood legs optional*	Hardwood
7	4	Glides optional*	Nylon
8	2	Arm caps wood optional*	Hardwood
9	2	Arm caps corian optional*	Solid Surface
10	2	Arm caps rigid polyester optional*	Polyester
11	2	Arm caps polyurethane optional*	Polyurethane
12	1	Seat pan optional*	Steel
13	1	Dust cover	Non-woven Polypropylene
14	Various	Upholstery pieces	Vinyl or Fabric
15	Various	Various fasteners	Steel

End of Life Recovery Options

Verity Lounge Series- VL-100/200/300-FA-BH

Identification of Materials		Material Recovery Opportunities		
Material	Example Components	Recycling Note	Higher Value Opportunity	Lower Value Opportunity
Please visit www.recyclingmarkets.net to find a recycling outlet nearest to you				
Plastic				
Nylon (PA)	Glide	Actively recycled into raw polymer by industrial plastic recyclers. It is important to note, however, that recycled plastic markets are highly variable and acceptance of a given material fluctuates based upon multiple factors (e.g. material type, quantity, presence of contaminants, markets for that material, etc.). Recycling value is improved with greater quantities and accurate material identification (i.e. identified by base polymer, filler, and additive content)	Recycled PA Regrind	Mixed Thermoplastic Compression Molding
Polyester Resin (PET)	Arm Caps (optional)		Recycled PET Regrind	
Polyurethane Rigid (PU)	Arm Caps (optional)		Recycled PU Regrind	
Polyurethane Foam	Foam cushioning	Actively recycled by foam manufacturers and recyclers into carpet padding.	Recycled Carpet Padding	
Corian® Solid Surface	Arm Caps (optional)	Not currently actively recycled due to process and economic limitations. Reuse or refurbishment are currently the best options for these materials. As a low value option, the energy content can be reclaimed in a designated waste-to-energy facility equipped with proper pollution control technologies.	Not Actively Recycled (Currently)	
Metals - Ferrous (e.g. Steel, Iron)				
Steel	Leg (optional), Fasteners, Seat pan	Actively recycled into raw ferrous metal ingot. Ferrous metals are easily separable from other materials through shredding and magnetic separation. Therefore, many metal recyclers will accept ferrous metals which contain small amounts of mixed materials (e.g. plastic, aluminum).	Recycled Steel Ingot	Off Grade Ferrous Ingot
Wood / Biobased Materials				
Plywood	Seat and Back frame,	Not currently actively recycled due to process and economic limitations. Reuse or refurbishment are currently the best options for these materials. As a low value option, the energy content can be reclaimed in a designated waste-to-energy facility equipped with proper pollution control technologies.	Not Actively Recycled (Currently)	Waste to Energy
Hardwood	Leg (optional), Arm cap (optional)			

End of Life Recovery Options

Verity Lounge Series- VL-100/200/300-FA-BH

Textiles				
Natural Fabrics	Determined by customer at time of order.	Recycling possible into non-woven fabrics.	Recycled fibers into shoddy for use in non-woven products	Landfill Disposal
Polyester Fabrics	Determined by customer at time of order.	Recycling possible into raw polymer.		
Mixed Fabrics	Determined by customer at time of order.	Recycling possible into non-woven fabrics.		
Vinyl	Determined by customer at time of order.	Recycling possible only through extraction based processes.	Recycled PVC polymer through extraction based processing	